

administered according to the rules regulations and provisions hereinafter
1. The Trustees and the survivors of them or their the trustees for the
Upon trust to permit the same to be used in perpetuity as a non-sec-
calculated to promote the moral intellectual spiritual or physical im-
the name of Sisked Village Hall either gratuitously or in consideration of
2. The Trustees may permit the property hereby conveyed to be used for
any political party

3. The Trustees may from time to time permit the buildings for the
the purposes aforesaid and may permit the erection of additional build-

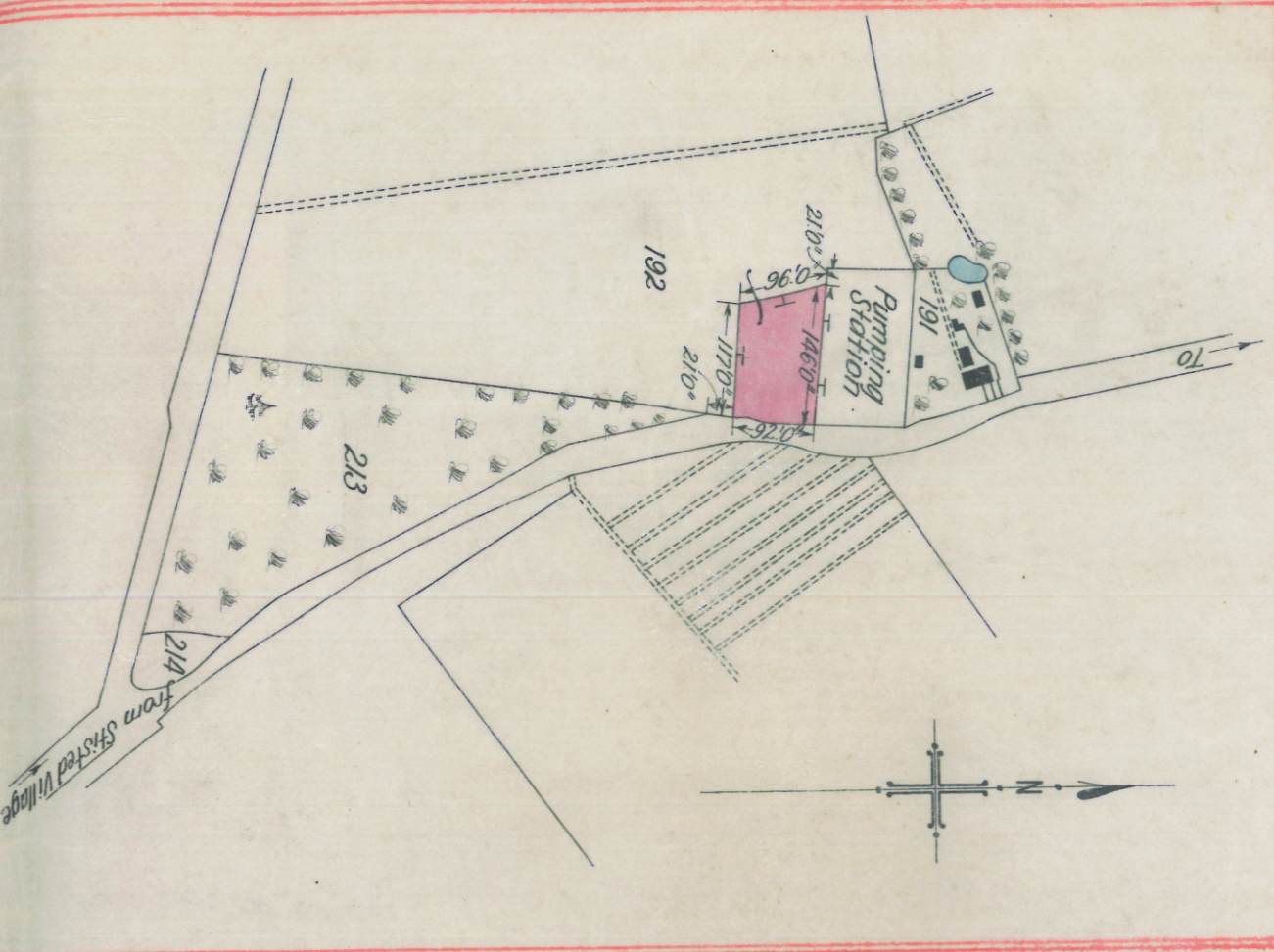

the Trustees annually at the said Annual Meeting in each year

(iii) The remaining two committee members in each of the cases refer-

toed one year of the said Parish of Sisked at the said Annual Meeting or

(iv) The names of the retiring committee members to be elected by the

shall be kept posted up on the principal outer door of the Village Hall

(v) Candidates for appointment as committee members shall be prop-

posed in person in that behalf fourteen days at least before the election on

principal outer door of the Village Hall

12. Casual vacancies among the elective committee members arising

shall hold office only while the committee members in whose place

13. Nowithstanding anything herein contained and in addition

committee members not exceeding four in number in any one year, so that

until the Annual Meeting of the Village Hall next after his appointment

14. Any committee member appointed by the Trustees shall have the

15. No person shall be eligible to hold office as a selective committee member until

14. The Trustees shall not be responsible for the
5. The management and control of the said
6. The committee shall consist of the Trustees
by the Sisked Men's Institute three by the Sisked
shall be those persons whose names and add-
7. To the three first elective committee mem-
of the Sisked Village Hall in the year One thou-
year One thousand nine hundred and forty one
in each succeeding year the committee member
8. To the three first elective committee mem-
Sisked Village Hall in the year One thousand nine
and forty one and the remaining one shall sim-
member who shall have been longest in office
9. To the two first elective committee members
Village Hall in the year One thousand nine hun-
dred and forty one and in each succeeding year the com-
10. Committee members to fill the places of the
and Parish Council respectively and the retiring
11. (i) If the said Men's Institute shall cease to
annually at the said Annual Meeting in each year
(ii) If the said Women's Institute shall cease to